



Official copy of register of title

Title number K448333

Edition date 15.05.1997

- This official copy shows the entries on the register of title on 31 OCT 2017 at 15:05:24.
- This date must be quoted as the "search from date" in any official search application based on this copy.
- The date at the beginning of an entry is the date on which the entry was made in the register.
- Issued on 31 Oct 2017.
- Under s.67 of the Land Registration Act 2002, this copy is admissible in evidence to the same extent as the original.
- This title is dealt with by HM Land Registry, Nottingham Office.

A: Property Register

This register describes the land and estate comprised in the title.

KENT : SHEPWAY

- 1 (26.01.1966) The Freehold land shown edged with red on the plan of the above Title filed at the Registry and being land lying to the north of St Mary's Road, Dymchurch.

B: Proprietorship Register

This register specifies the class of title and identifies the owner. It contains any entries that affect the right of disposal.

Title absolute

- 1 (18.10.1976) Proprietor: THE PARISH COUNCIL OF THE PARISH OF DYMCHURCH of 13 Orgarswick Avenue, Dymchurch, Romney Marsh, Kent.
- 2 The Transfer to the proprietor(s) contains a purchasers' personal covenant.

NOTE:-Copy of covenant in Certificate.

End of register

H.M. LAND REGISTRY		TITLE NUMBER	
		K 448333	
ORDNANCE SURVEY PLAN REFERENCE	KENT LXXXI 12	Scale 1/2500	
COUNTY KENT	DISTRICT SHEPWAY	© Crown copyright	

NOTE: AREAS ON THIS PLAN ARE EXPRESSED
IN ACRES

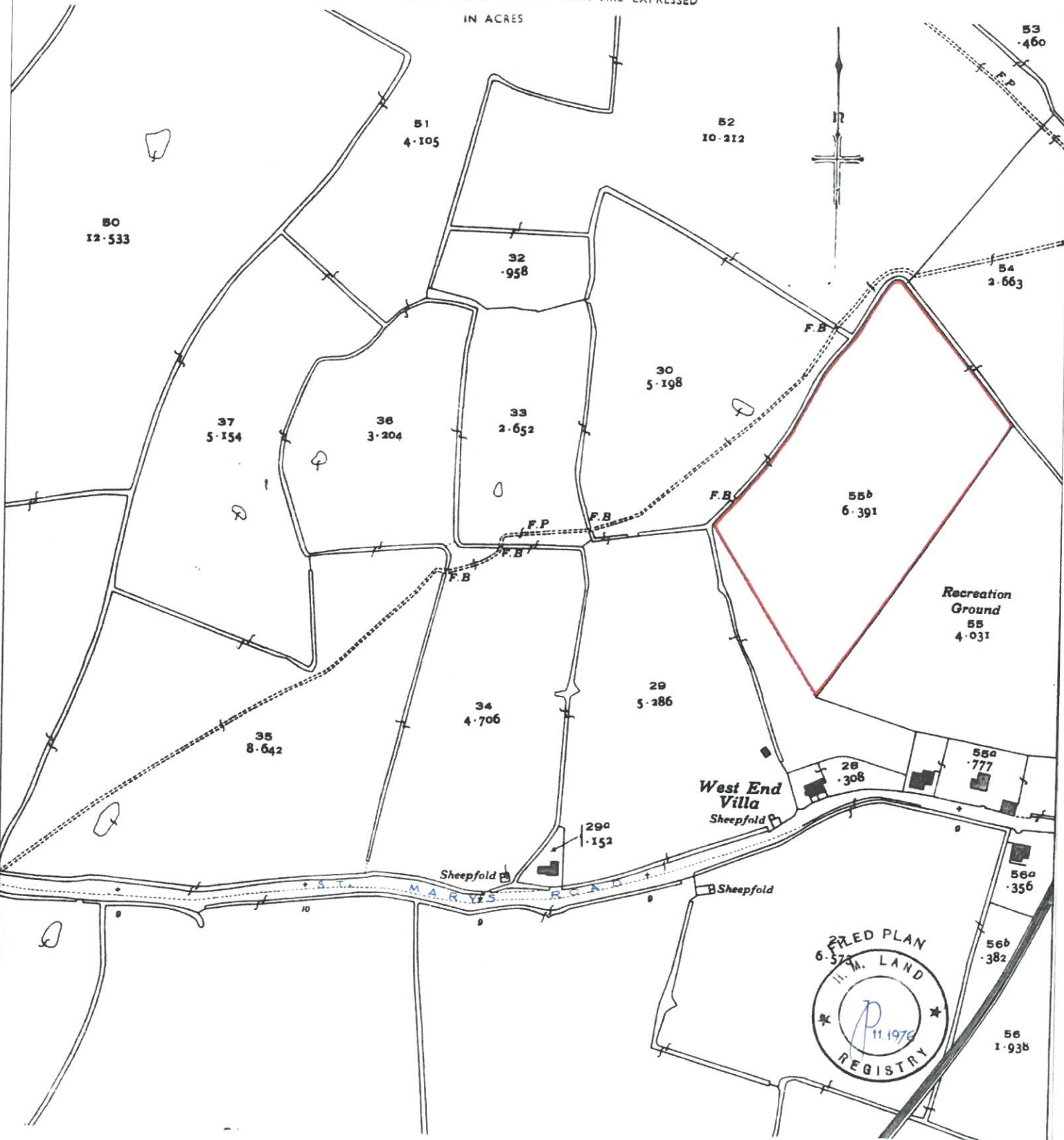

Stamp pursuant to section 28 of the Finance Act, 1931, to be impressed here.

When the transfer attracts Inland Revenue duty, the stamps should be impressed here before lodging the transfer for registration.

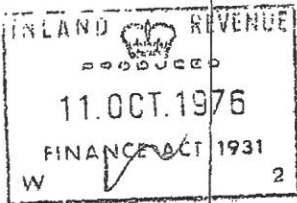

TRANSFER OF PART

NOT IMPOSING FRESH RESTRICTIVE COVENANTS*

(Rule 98 or 115, Land Registration Rules, 1925)

*Use form 43 when fresh restrictive covenants are imposed.

The Title number allotted to the land transferred will on registration be officially entered opposite:

K448333

Oyez Publishing Limited, Oyez House, 237 Long Lane, London SE1 4PU, a subsidiary of The Solicitors' Law Stationery Society, Limited.

January, 1974

County, County borough or London borough } KENT - SHEPWAY

Title number K260926

Property Land on the North Side of St. Mary's Road, Dymchurch.

Date Thirtieth September 1976

In consideration of SEVEN THOUSAND pounds (£ 7,000.00)

(1) Strike out if not required.

(1) the receipt whereof is hereby acknowledged

(2) Insert in BLOCK LETTERS, full name, postal address and description of the proprietor of the land.

(2) CHARLES HERBERT UDEN of Brookside, 36 St. Mary's Road, Dymchurch, Romney Marsh, Kent - Farmer and Grazier (hereinafter called "the Vendor")

(3) If desired or otherwise as the case may be (see rules 76 and 77).

(3) as beneficial owner hereby transfers to:

(4) Insert in BLOCK LETTERS, full name, postal address and description of the transferee for entry on the register.

(4) THE PARISH COUNCIL OF THE PARISH OF DYMCHURCH in the County of Kent (hereinafter called "the Council")

(5) For notes as to plan see page 4.

the land shown and edged with red on the (5) plan bound up within and known as land part of land on the North Side of St. Mary's Road Dymchurch being part of the land comprised in the title above mentioned. The Council hereby covenants with the Vendor forthwith to erect and forever

[OVER

hereafter to maintain a stock proof fence between the points
marked 'A' 'B' and 'C' shown on the said plan annexed hereto

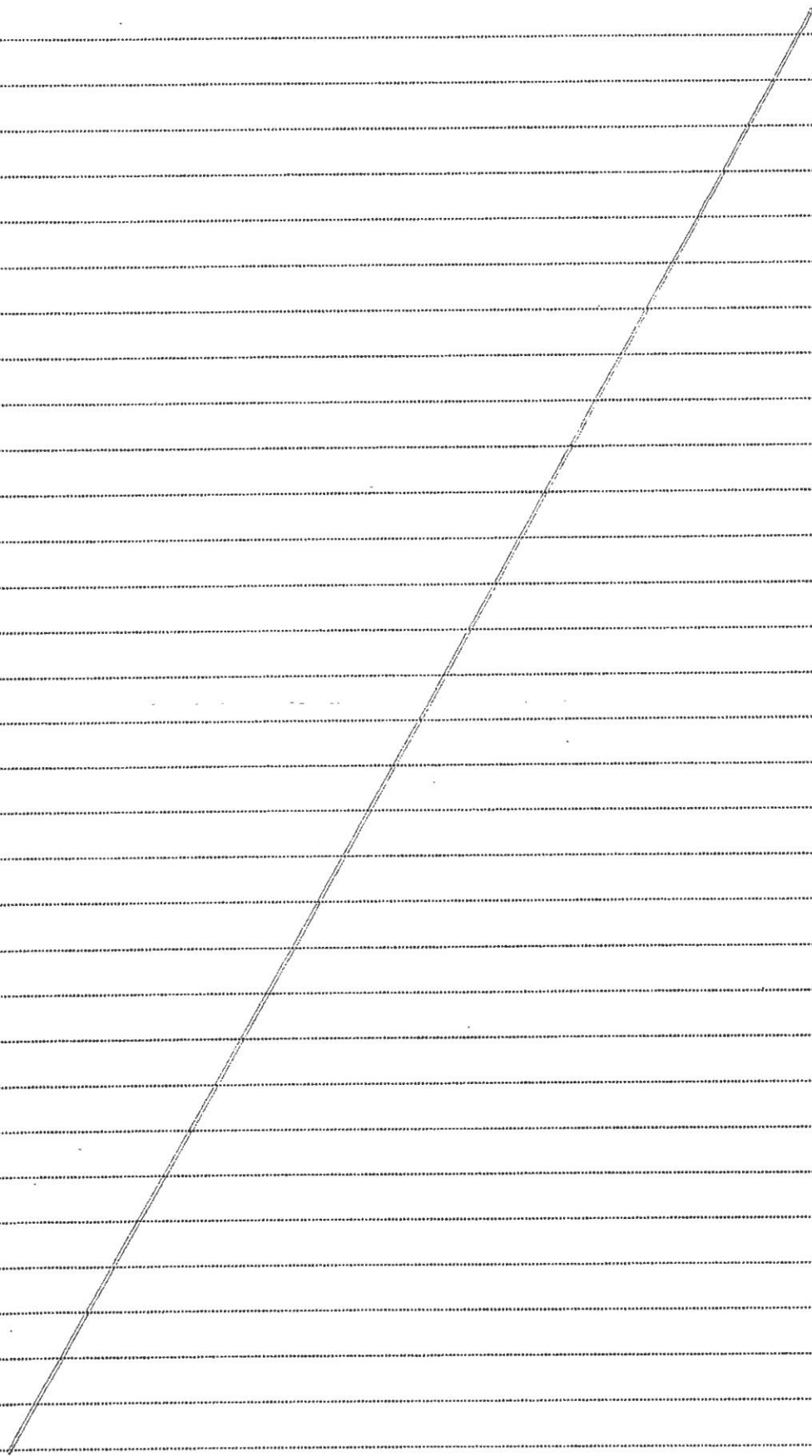

If space is not sufficient, additional sheets may be used, provided they are securely sewn hereto; the execution and attestation should in that case be added at the end.

(1) If a certificate of value for the purposes of the Stamp Act, 1891, and amending Acts is not required, this paragraph should be deleted.

(1) It is hereby certified that the transaction hereby effected does not form part of a larger transaction or series of transactions in respect of which the amount or value or aggregate amount or value of the consideration exceeds £ 15,000.00

Bind the plan herein

(2) For use when the transferor is a company or corporation.

(2) The common seal of _____
_____ }
was hereunto affixed in the presence of

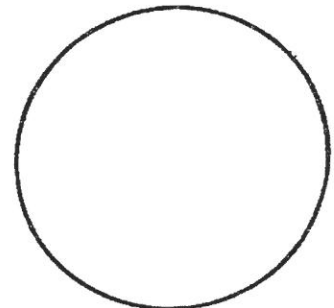

(3) Or other officers authorised by the articles of association, charter, etc. (See footnote).

_____ (3) Director
_____ (3) Secretary

(4) For use by transferor(s) other than a company or corporation.

(4) Signed, sealed and delivered by the
said CHARLES HERBERT UDEN

C. H. Uden

in the presence of

Name K. Milled

Address 73 High Street Hythe Kent

Description or occupation Scientist

(4) Signed, sealed and delivered by the
said Peter Francis Cooper

and Antony Holland Deighton

two Members of the Council on behalf of the Council
at a Meeting of the Council held on the _____
day of _____ in the presence of _____

1976 Name J. U. Edwards

Address 11 Wind Close, Dymchurch Kent

Description or occupation Chair to the Parish Council.

Note: In the case of a company or corporation, unless the transfer has been executed in accordance with section 74 (1) of the Law of Property Act, 1925, it should be accompanied by a certificate signed by the secretary or solicitor of the company or corporation that the transfer has been duly executed in accordance with the company's articles of association or the corporation's statute, charter, etc.

[OVER

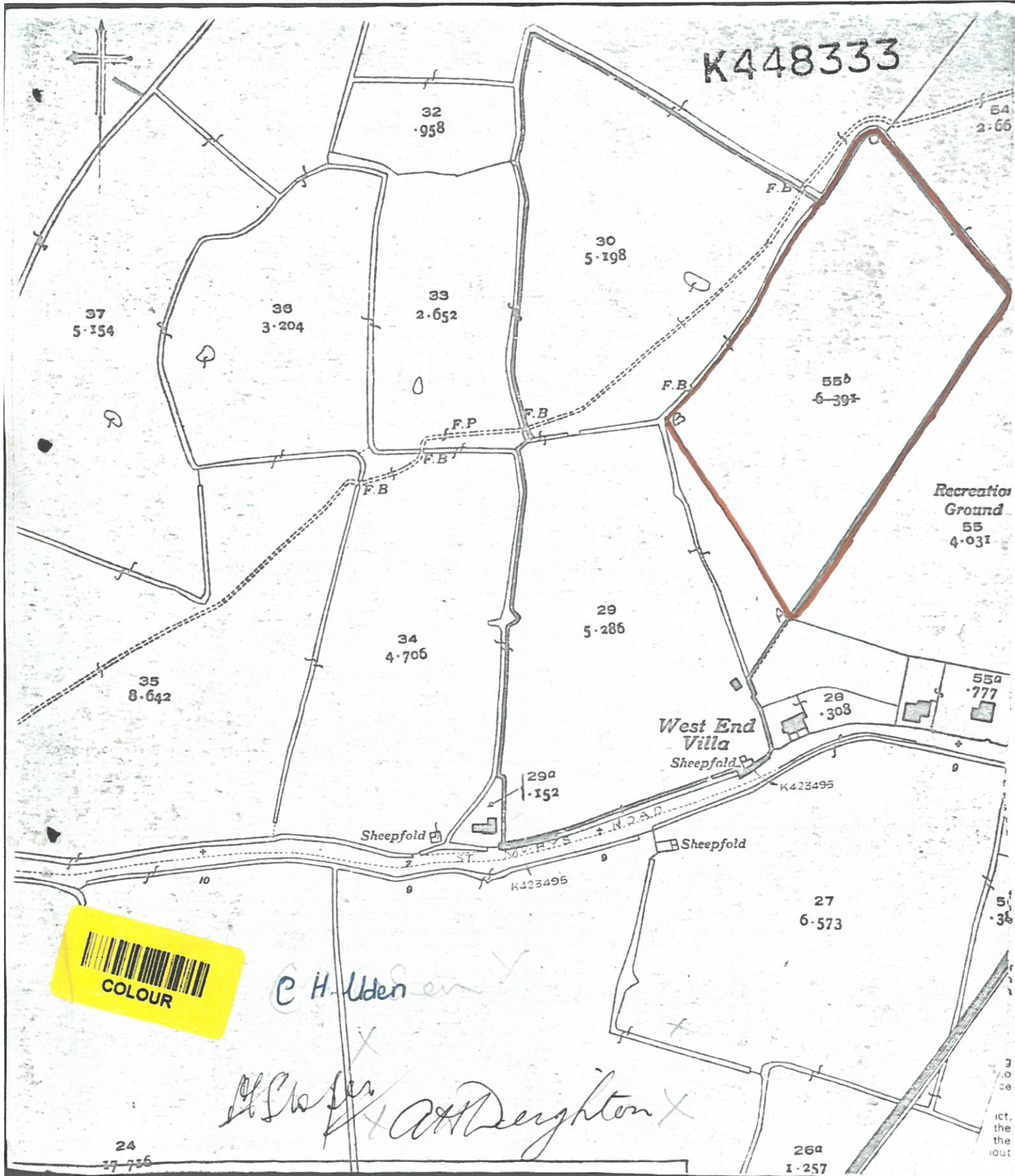

This official copy is incomplete without the preceding notes page.